

Brush strip change

The brush strip of the SEBO Kombi can easily be removed for cleaning or replacement.



1. To make the brush strip easier to grasp, push the 'down' foot switch to lower it.



2. Now gently ease out the yellow locking insert with a narrow screwdriver.



3. Then gently remove the brush by holding a length of bristles and sliding it out. Once replaced please remember to replace the yellow insert.

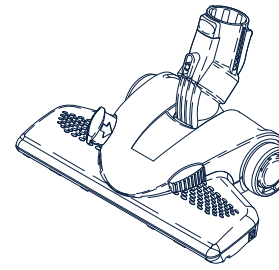

WORKS FOR ME

SEBO KOMBI Art-No: 7260GS/ 7240GS ADVANCED SETTINGS

Brush strip change
Thread lifter replacement
Improving edge suction

Dear SEBO customer,

thank you for choosing a SEBO vacuum cleaner. When developing our vacuum cleaners, we make every effort to meet the standards and regulations of the countries they are sold in, and to offer you the best possible performance. The EU Ecodesign Regulation, which came into force in 2014, has had a significant impact on vacuum cleaners, requiring, among other things, a reduction in power to less than 900 watts. This regulation also determines dust pick-up under laboratory conditions that are significantly different from the real conditions found in typical households. As it is delivered, the SEBO Kombi meets the requirements of this Ecodesign regulation, but can be adapted to work better in more realistic situations by means of the settings described below. Only SEBO, the world-wide floor care expert, offers this possibility.

Thread lifter replacement

The factory installed red, flat thread lifters (7297ER), are optimised for dust pick-up under laboratory conditions, rather than fibre pick-up, as the Ecodesign Regulation specifies 100% dust for the test. However, normal household dirt usually consists of about 50% fibres (from textiles, hair, etc). The brown, rounded thread lifters (7237ER) significantly increase fibre pick-up and reduce pushing force. They will normally give better pick-up in the typical home.

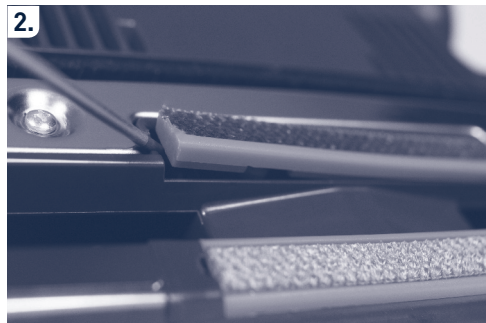
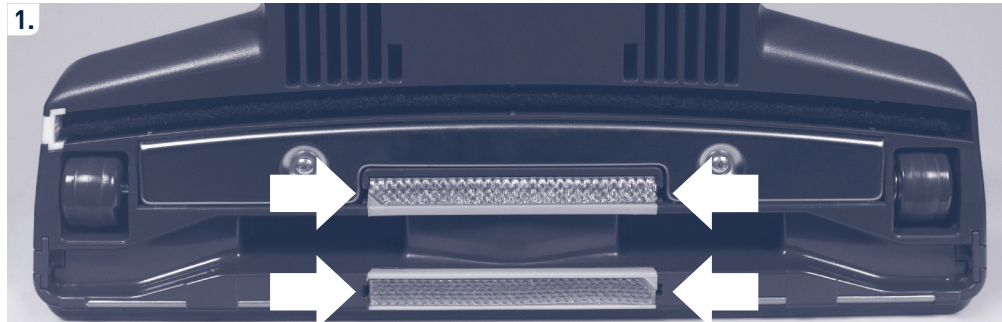

Remove the red, flat thread lifters by inserting a narrow-bladed screwdriver into the indentations on either side and gently prising up the inserts.

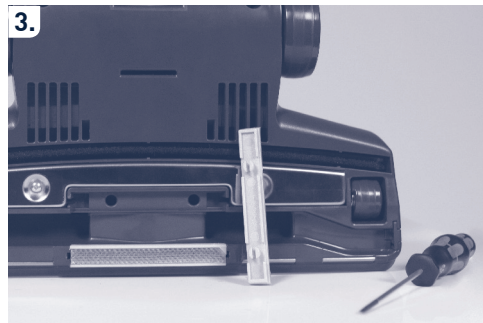

Fit the brown, rounded thread lifters in the same place and let them snap into position with a little pressure.



Attention: The thread lifters can only be fitted in one way round!

Improving edge suction

As delivered, with closed suction channels, the SEBO Kombi is optimised for Eco-design test requirements. However, the edge suction is reduced (e.g. for skirting boards) and the pushing force of the floor nozzle is increased. If you open both sides of the suction duct according to the following instructions, larger particles, up to approx. 2 cm, to the side of the SEBO Kombi nozzle, can be picked-up and the pushing force is noticeably reduced.

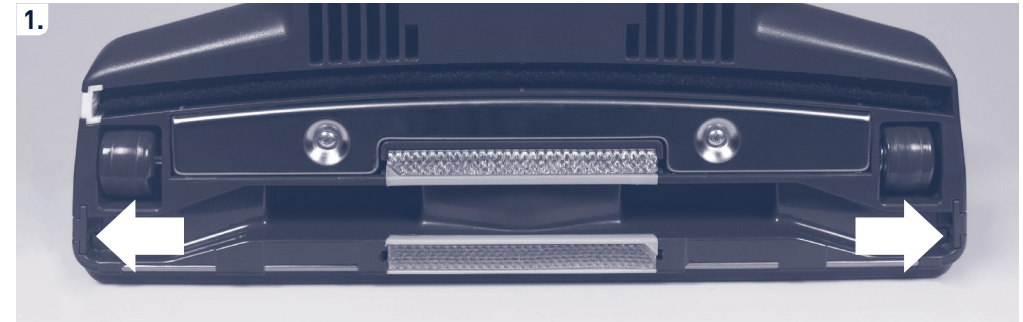

Lift the suction channel end closure by gently prying it upwards with the help of a screwdriver.



Rotate the closure by 180° so that the gap points upwards and the narrow nose faces outwards. Snap the closure into its original location and repeat the procedure on the other side.