



MADE IN GERMANY

SEBO duo
BRUSH MACHINE

OWNER'S MANUAL

For Household Use Only



TABLE OF CONTENTS

Technical Details	2
Wiring Diagram	2
How to Contact Sebo.....	2
Important Safety Instructions	3
Special SEBO duo Carpet Cleaning Product Features	4
The Advantages of Using the SEBO duo Cleaning System	4
How it Works	4
The SEBO duo-P Powder.....	4
Identification of Parts	5
Assembly	5
Attachments, Accessories and duo Powder.....	6
Operating Instructions.....	7
Starting the Machine	7
How to Use the duo Cleaning System	8
Cleaning the Entire Carpet	8
Spot Cleaning Stains	8
Important Product Tips	8
Maintenance	9
Removing the Brushes.....	9
Cleaning the Brushes	9
Replacing the Brushes	9
Trouble-shooting Guide	9
duo Brush Machine Schematic and Part Numbers	10

TECHNICAL DETAILS

Brush motor	1.8 amps
Width	14 inches
Height	4-11/16 inches
Body weight	11 lbs.
Brush speed	400 rpm
Cord length	40 feet
120 VAC	50-60 Hz

WIRING DIAGRAM

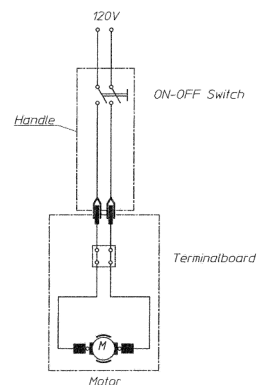

HOW TO CONTACT SEBO

To contact SEBO in the United States of America:
 SEBO America, LLC
 Telephone: (800) 334-6614 • Fax: (303) 792-9196
 Website: www.sebo.us

To contact SEBO in Canada:
 Floor Care Equipment, Ltd.
 Telephone: (800) 661-8687 • Fax: (800) 270-4807
 Website: www.sebocanada.ca

For Warranty coverage information please refer to your Warranty Card included with your SEBO machine.

IMPORTANT SAFETY INSTRUCTIONS



READ ALL INSTRUCTIONS BEFORE USING THIS MACHINE

When using an electrical appliance, basic precautions must always be followed. The use of the machine is at your own risk. The manufacturer/supplier is not liable for any injury or damage caused by incorrect usage of the machine. Always check the cleaning and maintenance instructions of your floor manufacturer.

To reduce the risk of electric shock, this brush machine has a polarized plug; one blade is wider than the other. This plug will fit in a polarized outlet only one way. If the plug does not fit fully in the outlet, reverse the plug. If it still does not fit, contact a qualified electrician to install the proper outlet. Do not change the plug in any way. Connect only to the outlet type specified on the serial number plate underneath the machine.

SAVE THESE INSTRUCTIONS.

WARNING! *The quality, condition, coating, texture, age and manufacturing technique of all floor surfaces vary. Therefore, machines with rotating brushes, including your SEBO duo brush machine, may damage some floor coverings or surfaces. Berber carpets, long shag, specialty and delicate or hand-woven carpets are particularly vulnerable to damage by rotating brushes. Always consult the materials supplied by your floor's manufacturer for information on proper upkeep and cleaning. To ensure that your SEBO duo brush machine is compatible with your floor coverings, please test the duo-P cleaner and brush machine on each type of carpeting in a small inconspicuous area to determine if any damage occurs. If damage occurs, stop using the brush machine and powder immediately! An operating machine should not stand stationary on the floor for inappropriate periods of time. Damage could occur. Do not run the machine on flooring not covered by carpet.*

WARNING! To reduce the risk of fire, electric shock, injury or damage:

1. Do not leave brush machine while plugged in. Unplug from outlet when not in use and before servicing.
2. Do not use outdoors, on wet surfaces or on inappropriate surfaces, e.g. stone or concrete.
3. Do not use near small children or pets. Do not allow to be used as a toy. Use of this product by children should always be supervised by an adult.
4. Use only as described in this manual. Use only manufacturer-recommended attachments.
5. Do not use with a damaged cord or plug. If brush machine is not working as it should, has been dropped, damaged, left outdoors, or dropped into water, take it to a SEBO service center.
6. Do not pull or carry by cord, use cord as a handle, close a door on cord, or pull cord around sharp edges or corners. Do not run machine over cord. Keep cord away from heated surfaces.
7. Do not unplug by pulling on cord. To unplug, grasp the plug – not the cord.
8. Do not plug in if switch is in the "I" (ON) position.
9. Do not use outlets above counters to plug in vacuum – damage to items in the surrounding area could occur.
10. Always carry the polisher over steps and sills.
11. Do not handle plug or vacuum handle with wet hands.
12. Do not put any object into machine openings. Do not use machine with any openings blocked. Keep openings free of lint, hair, and anything that may reduce air flow.
13. Do not remove any screws from machine.
14. Do not run machine over anything that is burning or smoking, such as cigarettes, matches, or hot ashes.
15. Turn off all machine controls before unplugging.
16. Use extra care when cleaning on stairs.
17. Do not turn on the machine with the storage tray still attached.
18. Do not use machine to clean up flammable or combustible liquids such as gasoline or use in areas where they may be present.
19. Machines can cause a fire when operated near flammable vapors or materials. Do not operate this machine near flammable fluids, dust or vapors.
20. Maintenance and repairs must be done by qualified personnel.
21. Use only original SEBO replacement parts.
22. Do not use machine as a step.
23. Do not leave machine standing in one place with machine turned on. This may damage carpet.
24. Keep hair, loose clothing, fingers, and all parts of body away from machine openings and moving parts. Do not place fingers or other body parts under machine, unless it is unplugged.
25. Do not place the brush head over fringes on a carpet or rug.
26. Store the brush machine in a dry place at room temperature. When the machine is not in use, you should wrap the cord on the cable hooks.
27. Any other servicing should be performed by an authorized service representative.

SEBO duo CARPET CLEANING SYSTEM PRODUCT FEATURES

Your SEBO duo Cleaning System is formulated to deep clean your entire carpet or spot clean stubborn stains without soaking your carpet. Dry cleaning is safer for most carpets – it will not shrink the carpet or cause water staining if applied unevenly. SEBO duo-P Cleaning Powder leaves no detergent residue to cause your carpet to resoil, and the carpet can be used immediately after cleaning.

Because this is a DRY cleaning process, the SEBO duo-P Cleaning Powder will not promote the growth of mold and fungus in your carpet and pad that wet extraction systems may cause. In addition, the GAF allergy research center in Germany found in a long term test that, six months after a single cleaning with duo-P, seven out of ten carpets remained free of dust mite allergens.

The Advantages of using the SEBO duo Cleaning System are:

- No detergent residue
- Alleviates house dust allergies
- Easy spot cleaning
- A built-in fiber protector helps to protect your carpet against future stains and soil
- No shrinkage or mildew
- No need to move furniture
- Cleans most types of carpets
- Immediate use of the carpet

How it Works:

The SEBO duo-P Cleaning Powder is made up of granules that are moistened with detergent and is environmentally friendly and safe to use. When the granules are worked into the carpet fiber, soil and stains are lifted out of the carpet by the duo-P powder. The duo Brush Machine lifts the carpet pile ensuring all surfaces of the fiber are cleaned, leaving your carpet revived and softer. After vacuuming, the duo-P powder is removed, and your carpet is left clean, dry and ready for use.

An added advantage in using duo-P Cleaning Powder on your carpet is that once applied, a built-in fiber protector will help to protect against future damage from soiling or staining.

IDENTIFICATION OF PARTS

1. Handle
2. On/Off switch
3. Cable hooks
4. Handle connector
5. Swivel neck
6. Brushes
7. Storage tray
8. Spot cleaning brush
7. Storage tray
8. Spot cleaning brush
9. duo-P Cleaning Powder

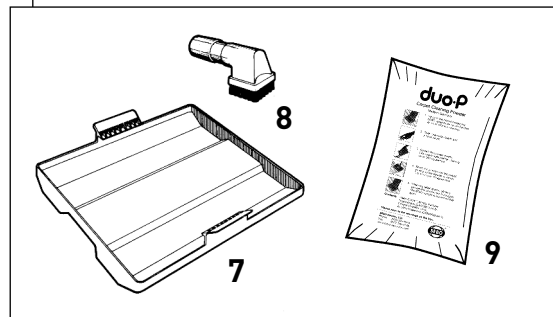
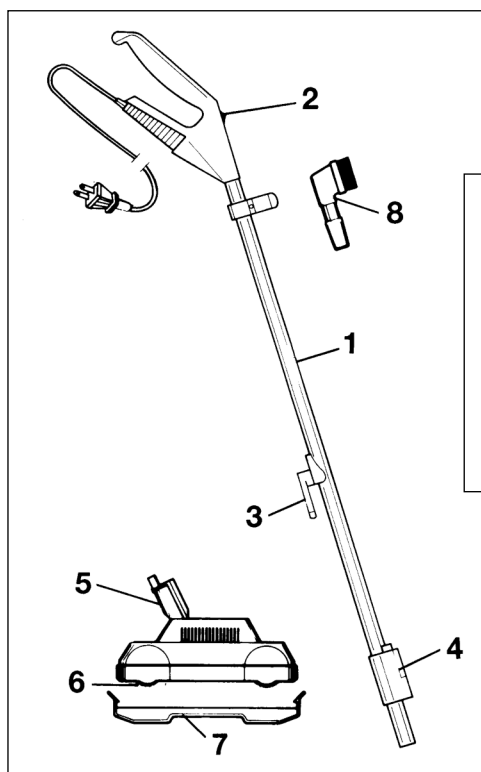

ASSEMBLY

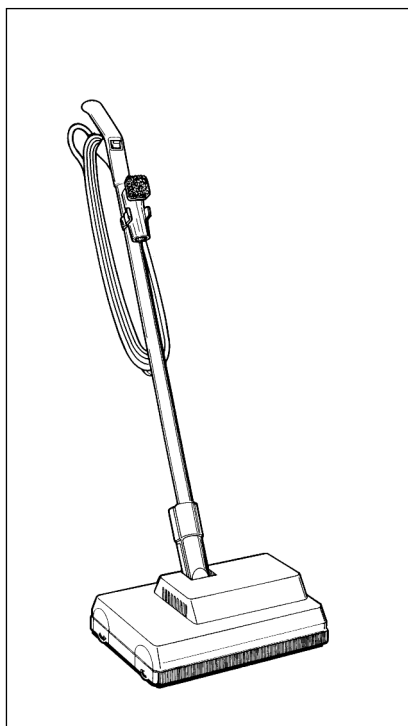

Press the plunger button (10) and insert the handle (1) into the swivel neck (5). With the plunger button released, the handle should remain firmly engaged. Pushing the handle forward sets the handle into the storage position. Pulling back releases the handle into the operating position.

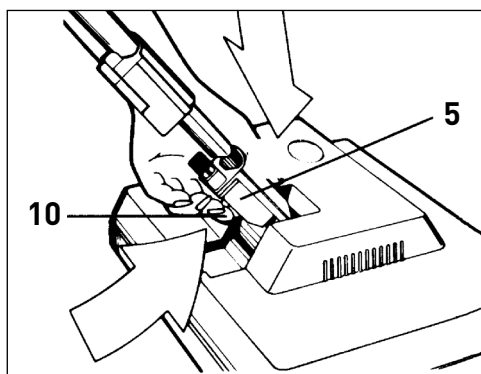

ATTACHMENTS, ACCESSORIES & duo POWDER

The SEBO duo-P Clean Box contains a 1.1 lb. bag in an environmentally friendly refillable container, and the underside of the lid has a built-in brush for spot cleaning. When you have used the contents, you can replace the inner bag with an inexpensive refill pack of duo-P Cleaning Powder.

The duo Daisy and Hand Brushes provide quick, convenient cleaning. The duo Daisy Brush is a single brush and is not

motorized. Its adjustable handle and light weight allows cleaning in a comfortable, upright position and it can clean both small and medium-size carpeted areas, such as hallways. The Daisy offers two brush bristle options for different types of carpet - easy or aggressive.

The duo Hand Brush can be used to clean small areas of carpet and upholstery in homes, cars, boats and RVs.

Attachments

Included



duo Spot Cleaning Brush
#3055HG
with Mounting Clip
#5352HG



Four refill bags
containing 1.1 lbs. each

Accessories, duo Powder and Wear Items



duo Daisy Brush
#CD100AM



duo Brush Roller
#3005ER



duo Soft Brush
Roller
#3005W



duo-P Clean Box
with built-in spot
cleaning brush
Contains one 1.1 lb
refill bag
#0478AM



duo Hand Brush
#6392



duo-P Refill Package
Contains five
1.1 lb refill bags
Each 1.1 lb bag can
clean up to 250
square feet of carpet.
#0472AM

OPERATING INSTRUCTIONS

A. Before turning on your brush machine, remove the machine from the storage tray (7) by pressing down the catch (15) and lifting the machine upwards by the handle (figure 1).

To replace the machine into the storage tray after use, first unplug the machine, then lower the head onto the tray until the tray snaps into place (figure 2).

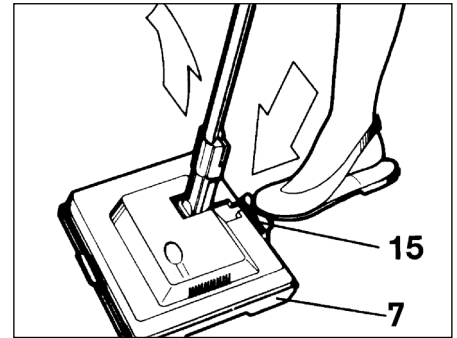

Figure 1

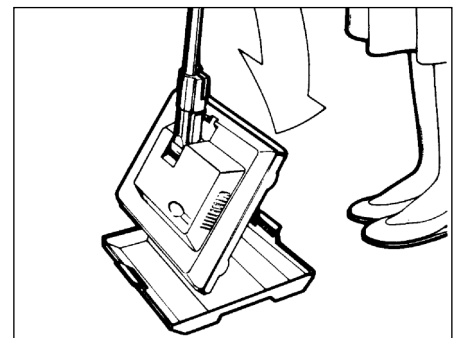

Figure 2

Starting The Machine, Figures 3 & 4

B. Before turning on your brush machine, make sure that the storage tray has been removed (see above) and that you have a firm hold on the handle grip to keep the machine from moving forward.

1. Turn the quick release cable hook (14) to the up position by moving it to the left or right.
2. Release the power cord plug from the power cord and lift the cord (13) off of the upper cord hook.
3. With the switch (2) in the "O" (OFF) position, plug the polarized power cord into a 120 volt outlet located near the floor.

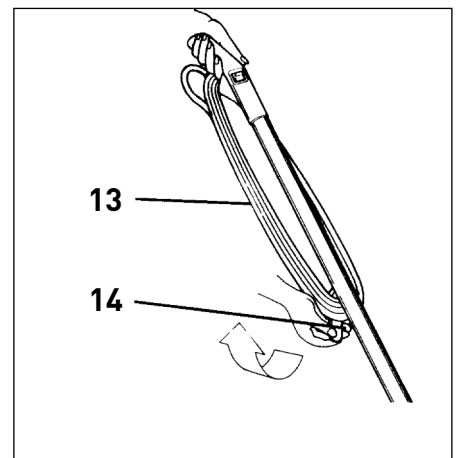

Figure 3

Switch Position

O = OFF

I = ON

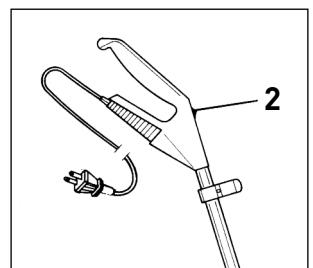

Figure 4

HOW TO USE THE duo CLEANING SYSTEM

Cleaning the Entire Carpet - Figures 5, 6, 7 & 10

First, vacuum your carpet prior to applying duo-P Powder. Then, spread duo-P Cleaning Powder evenly over the carpet. This can be done by spreading the powder directly out of the bag, or by spreading the powder by hand. Distribute the powder lightly, but evenly, over the area to be cleaned (figure 5). You need not use an excessive amount of powder for effective cleaning.

Work the powder into the carpet using the SEBO duo Brush Machine, which opens the carpet pile enabling the duo-P powder to clean around each separate fiber (figure 6). For smaller areas, the optional duo Daisy Brush can be used (figure 7).

Once the duo-P powder has absorbed all of the dirt and the area is dry to the touch (approximately 30 minutes), simply vacuum the area thoroughly (figure 10).

To Spot Clean Stains - Figures 5, 7, 8, 9 & 10

Vacuum any loose dirt or debris from area. If soiled area is wet, use white paper towels to absorb all moisture from the carpet. This will prevent the powder from “caking up” on the carpet and the brush. Then, spread a small amount of duo-P powder onto the soiled area.

Gently work the powder into the carpet using the spot cleaning brush (page 5, #8), the brush provided with the SEBO Clean Box (figure 8), the optional duo Hand Brush (figure 9) or the optional duo Daisy Brush (figure 7). Older or more stubborn stains may require further treatments. Simply repeat the process until the stain is completely removed.

Once the duo-P powder has absorbed all of the dirt and the area is dry to the touch (approximately 30 minutes), simply vacuum the area thoroughly (figure 10).

Important Product Tips:

- For best results, vacuum carpet prior to applying duo-P powder.
- Check a small, inconspicuous area of the carpet for colorfastness.
- Absorb any moisture from carpet using white paper towels before applying duo-P powder.
- Open window to speed drying.
- Reseal package after opening to maintain moisture. To ensure longer life of the powder, seal all opened packages inside of a zip-lock bag.
- Only moist powder will effectively clean. If powder becomes dry before it is used (e.g. powder left in an opened package), it will no longer work.
- Before using the SEBO duo-P Powder on your carpets, please read all instructions and warnings provided with the powder and all the instructions and warnings in this manual.
- Limited suitability for berber and needlepunch carpets.
- **Use caution if cleaning berber or looped pile carpeting with the brushing machine or when using the hand brushes. Test an inconspicuous area to determine suitability. Do not use on hand-woven or dyed carpeting. Check with the carpeting manufacturer for approved cleaning methods.**

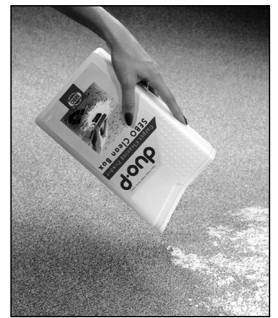

Figure 5



Figure 6



Figure 7

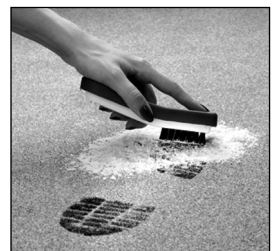

Figure 8



Figure 9



Figure 10

MAINTENANCE



Always unplug machine from the outlet before dismantling any part of the machine!

Removing the Brushes to Change or Clean - Figures 11 & 12

Remove the brushes (6), by unscrewing the two screws (17) at the end of each brush from the bearing block (18). Do not remove the screws that are recessed. Push the top of the brush and the block forward at the same time. Take the block off the brush, then, lift the brush upwards out of the brush housing.

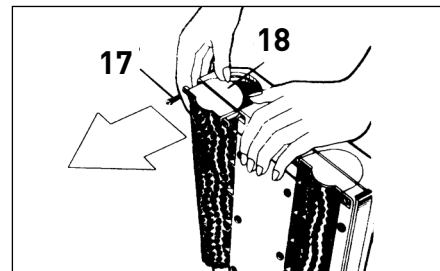

Figure 11

Cleaning the Brushes

The brushes must be removed from the machine to be thoroughly cleaned. See instructions above for removing the brushes. Clean by running your SEBO vacuum's suction hose, with crevice tool attached, up and down each brush to remove dirt and powder. Some carpet fibers, dirt and debris may require removal by hand. Replace the brushes - see instructions below.

A cursory cleaning of the brushes may be done without removing them, by unplugging the machine, turning the brush rollers upright, and using your vacuum's suction hose, with crevice tool attached, to remove the loose dirt or powder.

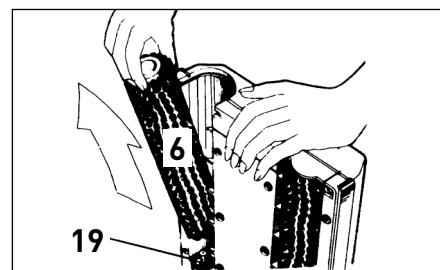

Figure 12

Replacing the Brushes - Figures 12 & 13

To replace each brush, insert the end with the slots into the housing and locate the slots over the drive cog (19) by turning the brush. Push the brush forward slightly to enable the bearing block (18) to be replaced, then push the block back into place in the brush housing and replace the two screws (17).



duo Brush Roller
#3005ER

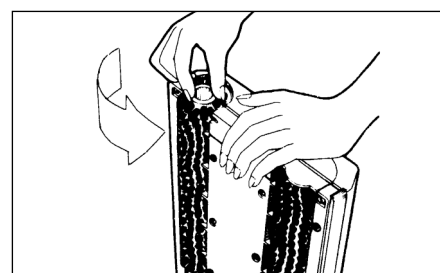

Figure 13

TROUBLE-SHOOTING GUIDE



Always unplug vacuum from outlet before dismantling any part of the machine!

PROBLEM	REASON	SOLUTION
Does not turn on or machine shuts off intermittently	1. Handle not fully inserted into the housing, causing a faulty connection.	1. See page 5 for how to insert handle.
	2. Not plugged into good outlet.	2. Use another outlet.
	3. Cable worn.	3. Replace cable.
	4. Brush has not been reinserted properly.	4. See page 9 for how to replace brush.
	5. Defective switch.	5. Return to your authorized SEBO dealer for repair.

duo BRUSH MACHINE

#9801AM Duo - Light Gray

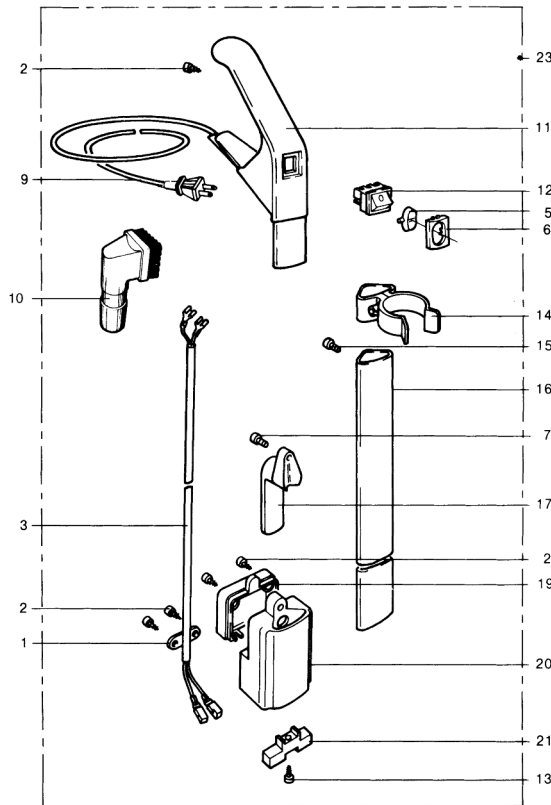

Handle Assembly

9401AM Duo Machine

- | | | |
|----|---------|---|
| 1 | 1030 UL | Cable clamp |
| 2 | 0106 | Screw 3.9 x 13 A2 |
| 3 | 3125 | Handle cable |
| 5 | 3137GS | Switch cap |
| 6 | 3136HG | Switch cap holder |
| 7 | 0127 | Screw taptite M4 x 10 |
| 9 | 5433DG | Cable - dark gray |
| 10 | 3055HG | Spot cleaning brush |
| 11 | 3142HG | Handle grip |
| 12 | 005113 | Rocker switch (incl. pos. 5-6) |
| 13 | 0105 | Screw 3.9 x 19 |
| 14 | 5352HG | Clamp |
| 15 | 0129 | Screw taptite M4 x 12 |
| 16 | 3115 | Handle tube available only as part of position 23 |
| 17 | 3118HG | Cable hook |
| 19 | 3027HG | Handle connector cover |
| 20 | 3113HG | Handle connector |
| 21 | 1020UL | Contact cover |
| 22 | 0103 | Screw 3.9 x 16 |
| 23 | 3122/H | Handle cpl. (incl. pos. 1-21) |

Power Head

- | | | |
|----|--------|----------------------------|
| 22 | 0103 | Screw 3.9 x 16 |
| 25 | 3033HG | Storage tray |
| 26 | 2007MG | Bumper |
| 27 | 3005ER | Brush roller |
| | 3005W | Soft brush roller |
| 28 | 3002SW | Base plate |
| 29 | 0112 | Screw M4 x 10 A2 |
| 30 | 3010HG | Bearing block RH |
| 31 | 3001HG | Brush housing |
| 32 | 3032 | Handle stop spring block |
| 33 | 0502 | Terminal block |
| 34 | 3049ER | Motor 120 V |
| | 05084S | Carbon brush set |
| 35 | 0141 | Locking washer |
| 37 | 3038 | Drive belt |
| 38 | 0176TL | Screw AM4 x 30 A2 DIN 7985 |
| 39 | 3004SE | Cover |
| 41 | 0149 | Spacer washer |
| 44 | 2438HG | Plunger button, complete |
| 45 | 2423 | Spring |
| 47 | 2022HG | Swivel neck cover |
| 48 | 3123HG | Swivel neck |
| 50 | 3051 | Swivel neck support |
| 51 | 3014 | Motor pulley |
| 52 | 3030 | Clamp |
| 53 | 3013 | Pulley |
| 54 | 3042 | Drive belt |
| 55 | 3022 | Gear wheel LH thread |
| 56 | 3036 | Spacer |
| 57 | 3037 | Shaft LH thread |
| 58 | 0222 | Ball bearing |
| 59 | 3015 | Pulley LH thread |
| 60 | 3039 | Bridge |
| 61 | 3035 | Shaft RH thread |
| 62 | 3021 | Gear wheel |
| 63 | 3018 | Pulley |
| 64 | 3071 | Clip |
| 65 | 3040 | End plate |
| 66 | 3009 | Pulley |
| 67 | 3028 | Spring |
| 68 | 3007 | Brush drive cog |
| 69 | 3074HG | Bearing block |
| 70 | 3052HG | Bearing block assembly LH |
| 71 | 3017 | Pulley |
| 72 | 3056 | Pulley 12R/Ms |

