



MADE IN GERMANY

SEBO DISCO

OWNER'S MANUAL

For Household Use Only

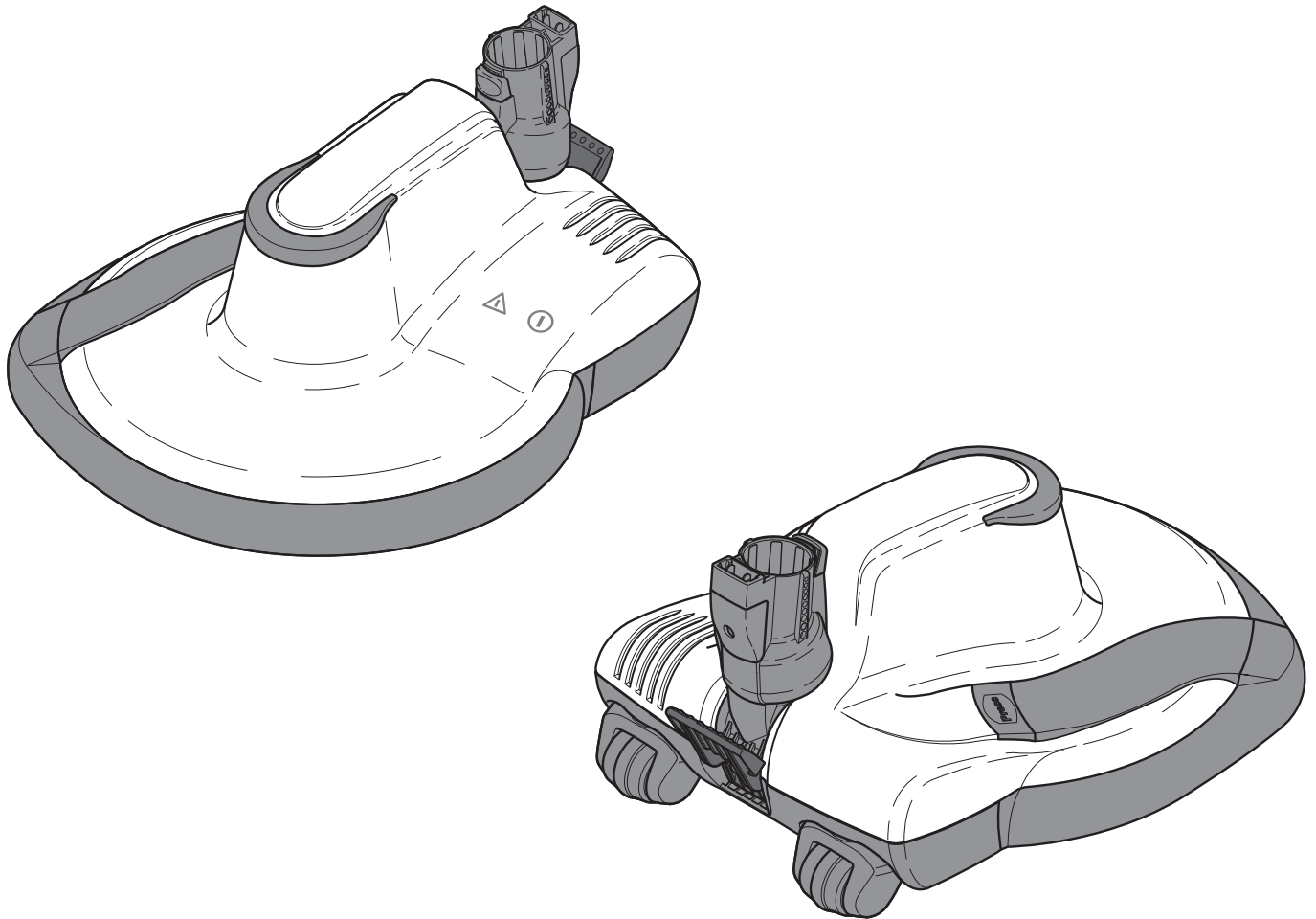

TABLE OF CONTENTS

Technical Details	2
How to Contact Sebo	2
Important Safety Instructions	3
Special SEBO Product Features	4
Automatic Pad Height Adjustment	4
Rotating Swivel Neck	4
Bumper Guards and Rolling Castors	4
Stationary Use Protection	4
Bag Full or Clog Warning – Auto Shut-Off	4
Identification of Parts	5
Optional Floor Pads	5
Assembly	5
Operating Instructions	6
Preparing the Floor	6
Floor Suitability	6
Starting the Machine	7
Operating the Machine	7
The LED Display	7
Maintenance	8
Changing the Floor Pad	8
Changing the Sealing Strip	8
Clog Removal	8
Clogs in the Floor Pad	8
Clogs in the Suction Duct	8
Clogs in the Swivel Neck	8
Trouble-shooting Guide	9
DISCO Floor Polisher Power Head Schematic and Part Numbers	10

TECHNICAL DETAILS

Motor	200 watts
Body weight	8.5 lbs
Motor protection	electronic cut-out
Working width	12 in.
Revolution speed	2,000 rpm
Floor height adjustment	automatic sensor control

HOW TO CONTACT SEBO

To contact SEBO in the United States of America:
 SEBO America, LLC
 Telephone: (800) 334-6614 • Fax: (303) 792-9196
 Website: www.sebo.us

To contact SEBO in Canada:
 Floor Care Equipment, Ltd.
 Telephone: (800) 661-8687 • Fax: (800) 270-4807
 Website: www.sebocanada.ca

For Warranty coverage information please refer to your Warranty Card included with your SEBO machine.

IMPORTANT SAFETY INSTRUCTIONS



READ ALL INSTRUCTIONS BEFORE USING THIS MACHINE

When using an electrical appliance, basic precautions must always be followed. The use of the machine is at your own risk. The manufacturer/supplier is not liable for any injury or damage caused by incorrect usage of the machine. Always check the cleaning and maintenance instructions of your floor manufacturer.

SAVE THESE INSTRUCTIONS.

WARNING! *The quality, condition, coating, texture, age and manufacturing technique of all floor surfaces vary. Therefore, machines with rotating pads, including your SEBO DISCO, may damage some floor surfaces. Some types of hardwood floors, cushion vinyl, cork and porous stone or tile are particularly vulnerable to damage by rotating brushes or pads. When possible, consult the materials supplied by your floor's manufacturer for information on proper upkeep and cleaning. To ensure that your new SEBO DISCO is compatible with your floor, please test the polisher on each type of flooring surface in a small inconspicuous area to determine if any damage occurs. If damage occurs, stop using the polisher immediately!*

WARNING! To reduce the risk of fire, electric shock, injury or damage:

1. The SEBO DISCO is for use only with SEBO FELIX vacuums. Do not use with any other manufacturer's vacuum cleaners.
2. Do not leave machine while plugged in. Unplug from outlet when not in use and before servicing.
3. Do not use outdoors or on inappropriate surfaces, e.g. stone or concrete.
4. Do not use on uneven floors.
5. Do not use on soft vinyl floors which are not stuck down as they could be sucked off the floor and damaged.
6. **The SEBO DISCO is for polishing dry hard floors only. Do not use on wet surfaces.**
7. Before using the machine, vacuum the floor thoroughly. Flooring may be damaged if particles of dirt are not removed before polishing.
8. Do not leave machine standing in one place with polisher turned on. Damage may occur.
9. Do not touch the floor pad or drive while the machine is operating.
10. Do not use DISCO without floor pad. Do not use without vacuum filter bag and/or filters in place.
11. Do not use near small children or pets. Do not allow to be used as a toy. Use of this product by children should always be supervised by an adult.
12. Use only as described in this manual.
13. Do not use with a damaged cord or plug. If vacuum or head is not working as it should, has been dropped, damaged, left outdoors, or dropped into water, take it to a SEBO service center.
14. Do not pull or carry by cord, use cord as a handle, close a door on cord, or pull cord around sharp edges or corners. Do not run over cord. Keep cord away from heated surfaces.
15. Do not unplug by pulling on cord. To unplug, grasp the plug – not the cord.
16. Do not plug in if switch is in the "I" (ON) position.
17. Do not use outlets above counters to plug in vacuum – damage to items in the surrounding area could occur.
18. Always carry the polisher over steps and sills.
19. Do not handle plug or vacuum handle with wet hands.
20. Do not put any object into polisher openings. Do not use machine with any openings blocked. Keep openings free of lint, hair, and anything that may reduce air flow.
21. Do not wash or reuse floor pad. Do not reuse vacuum filter bags or wash the filters.
22. Do not remove any screws from the DISCO.
23. Do not run the DISCO over anything that is burning or smoking, such as cigarettes, matches, or hot ashes.
24. Turn off all machine controls before unplugging.
25. Use extra care when using on stairs.
26. Do not use machine to vacuum up flammable or combustible liquids such as gasoline or use in areas where they may be present.
27. Machines can cause a fire when operated near flammable vapors or materials. Do not operate this vacuum near flammable fluids, dust or vapors.
28. Maintenance and repairs must be done by qualified personnel.
29. This machine should only be operated with SEBO floor pads and replacement parts. The use of non-genuine parts will waive the warranty for this product and could pose a serious safety risk.
30. Do not use DISCO head as a step.
31. Keep hair, loose clothing, fingers, and all parts of body away from vacuum openings and moving parts. Do not place fingers or other body parts under vacuum unless it is unplugged.
32. Do not place the DISCO head over rug or carpet edges. Do not use on carpet.
33. The vacuum has a manual reset thermal protector. The protector is reset by switching off the vacuum. The thermal protector needs some time to cool down after switching off! Check the vacuum for air blockages or mechanical failures before switching on.
34. Store the machine in a dry place at room temperature. When the machine is not in use, you should wrap the cord on the cable hooks.
35. Any other servicing should be performed by an authorized service representative.

SPECIAL SEBO PRODUCT FEATURES

Your SEBO DISCO ultra-high-speed suction polisher is a high quality, reliable, innovative product that has been developed and made in Germany with the most modern technology. The 2,000 rpm disc speed combined with an appropriate floor maintenance product creates a protective floor coating with a high gloss finish. By using the floor polisher at regular intervals, it will protect your hard floors against cracks, dirt and dampness and will retain the value and beauty of the surface. An important feature is its ability to “monitor” the resistance of the floor pad against the floor, so that the proper height is consistently maintained. In addition, the machine has warning systems and automatic shut-off capabilities that are designed to alert the user to machine problems that, if ignored, will damage the machine or diminish performance.

Your SEBO DISCO’S five most unique features are:

- 1. Automatic Pad Height Adjustment.** The SEBO DISCO adjusts the floor pad automatically to the appropriate floor height. The torque of the rotating floor pad is constantly measured ensuring optimal performance on hard floor surfaces.
- 2. Rotating Swivel Neck.** The 90° vertical and 180° horizontal turning swivel neck allows the SEBO DISCO to move with ease around furniture and into tight spaces
- 3. Bumper Guards and Rolling Castors.** The SEBO DISCO has two soft bumpers to protect your furniture and walls against scratches and scuffing. The DISCO head glides on three rubber-coated castors that will not mark your flooring. At the rear are two 360° flexible castors which are fixed on a solid steel shaft. The castor in the center supports and stabilizes the head. The flexible castors along with the turning swivel neck assure smooth maneuverability.
- 4. Stationary Use Protection.** When the machine has its handle in the upright-locked position, it is designed to disengage from the floor by raising the height of the floor pad. The pad will stop spinning. An operating machine should not stand stationary on the floor for inappropriate periods of time. If the floor pad should come in contact with carpet, the pad will raise from the floor and stop spinning.
- 5. Bag Full or Clog Warning – Auto Shut-Off.** If the polisher or vacuum’s air flow pathway becomes restricted due to a full bag or the existence of a clog, the red LED light located on top of the DISCO will illuminate. If the user ignores this warning for approximately 30 seconds, the machine will shut off. The user should turn the switch off, unplug the machine and immediately insert a new bag or remove the clog (to remove a clog, refer to the Clog Removal section on page 8). If the user restarts the machine without having solved the problem, the red LED light will again illuminate and the machine will shut off in 30 seconds.

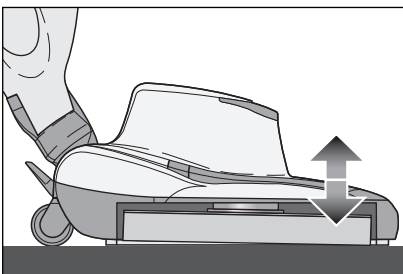

The floor pad automatically adjusts up or down for different hard floor heights.

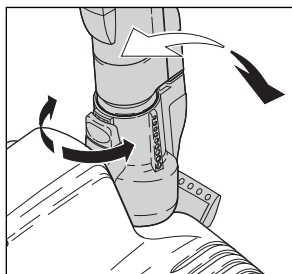

The swivel neck rotates 90° vertically and 180° horizontally.

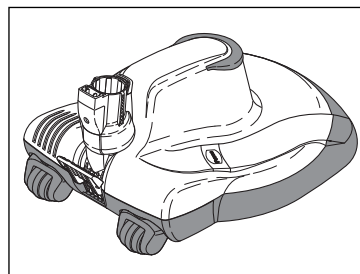

The upper and lower rubber bumpers protect furniture and walls, and the rotating rubber castors move smoothly across the floor.

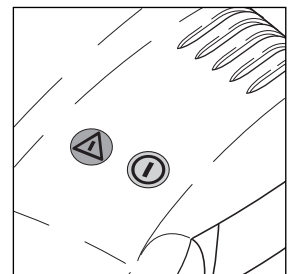

LED warning light display alerts user to a full bag or clog.

IDENTIFICATION OF PARTS

1. Bumper
2. Suction duct access cover
3. Bumper
4. Release button
5. Swivel neck
6. Head release button
7. Foot pedal
8. Clog/overload warning light
9. Power indication light
10. Support castor
11. Seal
12. Castor
13. Floor pad
14. Pad retainer

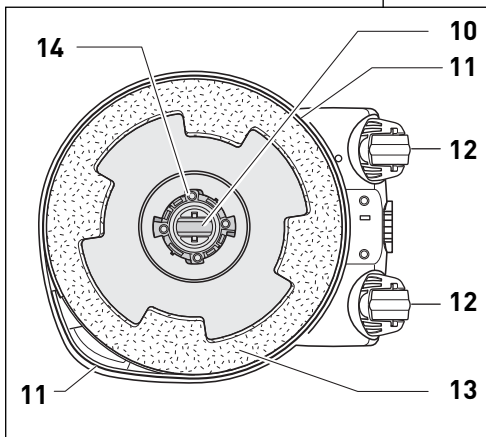
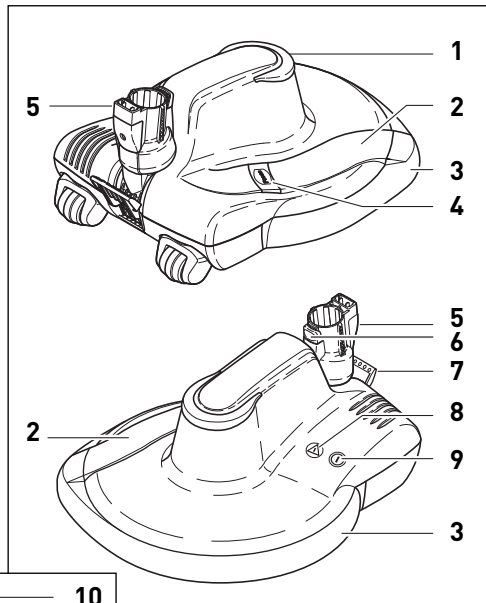

Floor Pads

Included

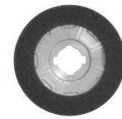

Blue Pad
#3230ER00

Optional
Three-step Pads

Step One

Step Two

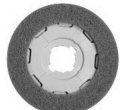
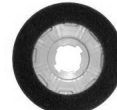

Red Pad

Yellow Pad

#3286ER40

Red and Yellow Pads in one box.

Step Three

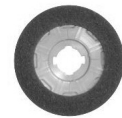

Green Pad
#3230ER30

The Blue Floor Pad is designed to maintain soft coatings, like wax, on hard floors, and it is suitable for daily use. It should be used along with a typical floor wax suitable for the specific floor surface or recommended by the flooring manufacturer. The optional Red, Yellow and Green Floor Pads restore the shine of dull, scratched and scuffed hard-floor surfaces without the use of water, chemicals or polishing sands. The pads do the work using a three-step procedure (soft coatings should not be present).

ASSEMBLY

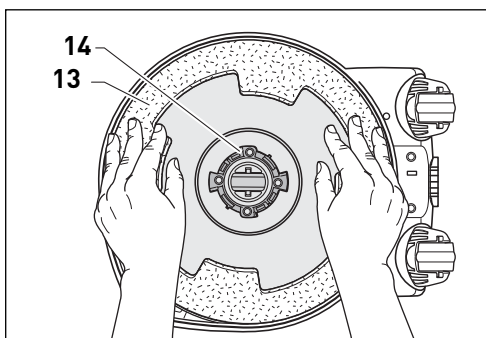

Figure 1

Fit the floor pad (13) to the pad retainer (14), using the notches as a guide for correct position. Press the pad down onto the pad retainer (14) until it locks in place. See figure 1.

Press the retainer tabs (15) in using your thumb and forefinger and turn the pad clockwise until it locks into place again. See figure 2

To attach the DISCO to your SEBO FELIX: place the DISCO on the floor with the swivel neck (5) upright. Hold the vacuum vertically and Insert the suction opening of the FELIX (16) into the swivel neck of the head. Push firmly and evenly downward until the head release button (6) snaps into the locked position. See figure 3.

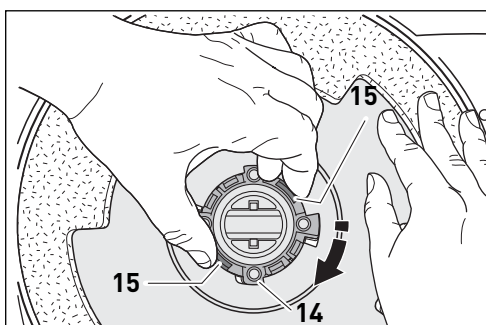

Figure 2

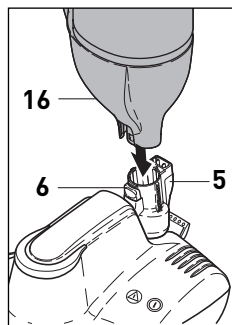

Figure 3

OPERATING INSTRUCTIONS

Preparing The Floor

Remove as much furniture as possible, and cover any left in place.

First Cleaning:

1. Vacuum the floor thoroughly before using the SEBO DISCO for the first time, ensuring it is completely free of debris, such as grit.
2. Add some floor maintainer to the water, as per the instructions, if required, and clean the floor with a mop. Wait for the floor to dry completely before proceeding to step 3.
3. Apply an appropriate floor maintenance product* in accordance with the instructions. Before polishing the floor, ensure that the floor is completely dry then proceed to step 4.
4. Move the SEBO DISCO slowly over the floor similar to how you would use your vacuum cleaner.

Intermediate Maintenance:

Regular polishing of the coating will maintain an even finish and will ensure a longer lasting bright appearance of the floor. Vacuum the floor first, before using the polisher, to remove dirt and dust.

NOTE: Vacuum the floor surface THOROUGHLY before using the polisher. Grit and debris left on the floor can cause damage. Always inspect the pad before use - any grit that becomes embedded in the pad can damage your floor.

Floor Suitability

* Please refer to the maintenance guide of the manufacturers of your floors for recommended maintenance and floor maintainers.



Suitable - The DISCO is usually suitable for the following types of floors:	Unsuitable** - The DISCO is NOT suitable for the following types of floors:
<ul style="list-style-type: none">• PVC (coated or uncoated vinyl or vinyl composite tiles).• Natural stone, such as granite, marble or terrazzo.• Acrylic or polyurethane-coated floor.• Hardwood with oil or varnish finishes.• Hardwood or other floors with soft-coated finishes, like wax (use the blue floor pad only).	<ul style="list-style-type: none">• Any floor on which a shiny finish is not desired.• Glazed, ceramic and porcelain tiles, or porous tiles such as terracotta and slate.• Cushioned vinyl, linoleum, laminate, and any floor types that are poorly bonded to the sub-floor.• All floors with textured or uneven surfaces or tiles with raised edges.• Floors with maintenance-free coatings, floors in which acceptability of the polisher is uncertain, or when polisher use is contrary to manufacturer recommendations.

** Please note that damage may occur if used on these types of floors.



WARNING! The quality, condition, coating, texture, age and manufacturing technique of all floor surfaces vary. Therefore, machines with rotating pads, including your SEBO DISCO, may damage some floor surfaces. Some types of hardwood floors, cushion vinyl, cork and porous stone or tile are particularly vulnerable to damage by rotating brushes or pads. When possible, consult the materials supplied by your floor's manufacturer for information on proper upkeep and cleaning. **To ensure that your new SEBO DISCO is compatible with your floor, please test the polisher on each type of flooring surface in a small inconspicuous area to determine if any damage occurs. If damage occurs, stop using the polisher immediately!**

Starting The Machine - Figure 4

Before turning on your vacuum cleaner with the DISCO attached, make sure that the vacuum handle is in its upright locked position and that you have a firm hold on the handle grip to keep the machine from moving forward.

Make sure that the ON/OFF Switch (19) of your SEBO FELIX (figure 4) is in the OFF position.

Switch Position

0 = OFF

I = ON

Release the power cord from the cord hook or reel and plug the polarized power cord into a 120 volt outlet located near the floor.

Press the power switch to the ON position.

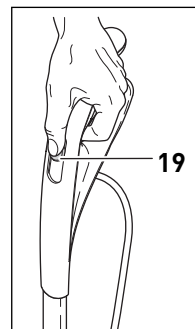

Figure 4

Operating the Machine - Figure 5

NOTE: The SEBO DISCO has a soft-start system, so there may be a slight delay before it operates.

When the machine is switched on with the handle in the upright locked position, the DISCO pad will automatically raise from the floor and will stop spinning. To release the polisher from the upright locked position, press down on the foot pedal (7) and lower the handle into the normal operating position. The DISCO pad will automatically lower to the appropriate height and will start spinning.

When finished, switch the machine off and remain holding the vacuum cleaner firmly until the floor pad stops rotating. Then, return the handle to its upright, locked position.

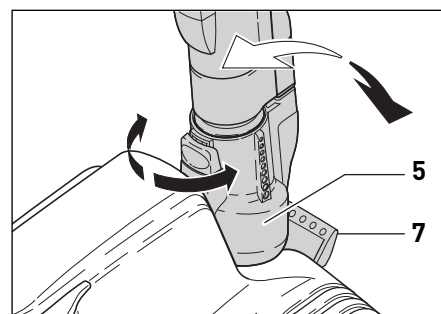

Figure 5

LED Display - Figure 6

The green LED light (9) indicates that the floor polisher is powered on and operational.

If the air flow pathway becomes restricted due to a clog or a full bag, the red LED light (8) will illuminate and the machine will shut off. If this occurs, turn the power switch off, unplug the machine and immediately check for clogs in the DISCO head (see "Clog Removal" on page 8). If no clog is found, check for clogs in the vacuum cleaner or for a full dust bag. Refer to your vacuum cleaner owner's manual.

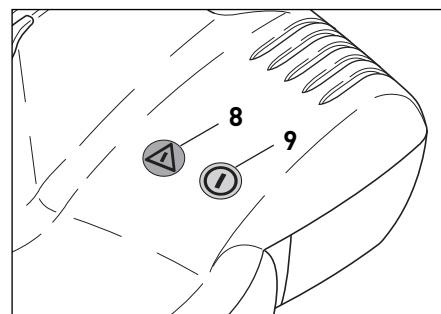

Figure 6

MAINTENANCE

⚠ Always unplug machine from the outlet before dismantling any part of the machine!

Changing the Floor Pad - Figures 7, 8 & 9

Check the floor pad regularly for sharp and abrasive materials such as grit, grains of sand, etc. If necessary, change the pad.

To change the floor pad, press the retainer tabs (15) inward using your thumb and forefinger. Rotate the pad (13) counter clockwise (figure 7). Lift the floor pad out.

To insert a new pad, fit the floor pad (13) to the pad retainer (14), using the notches as a guide for correct position. Press the pad down onto the pad retainer (14) until it locks in place. Next, press the retainer tabs (15) in using your thumb and forefinger and turn the pad clockwise until it locks into place again (figure 9).

Use only genuine SEBO replacement floor pads to ensure performance, longevity and safety.

The underside of the machine should be cleaned regularly.

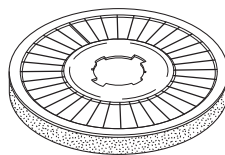

Blue Floor Pad
Part # 3231ER00

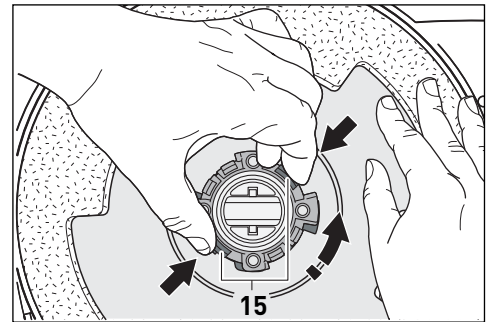

Figure 7

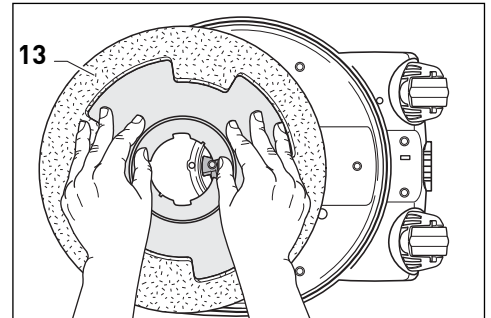

Figure 8

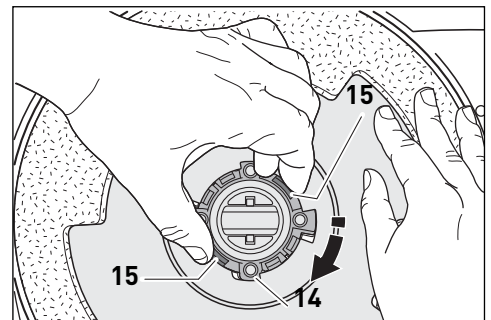

Figure 9

CLOG REMOVAL

⚠ Always unplug vacuum from outlet before removing any clogs!

Clogs in the Floor Pad - Figure 10

If a clog is indicated, check the pad area (20) first. Remove the pad (see instructions above). Check both sides for debris.

Clogs in the Suction Duct - Figure 11

To check the suction duct (21), push the release button (4) and remove the suction duct cover (2). Inspect the passage for debris.

Clogs in the Swivel Neck - Figure 11

To check for a clog in the swivel neck (5), remove the head by pressing the release button (6). Pull the vacuum out of the swivel neck. Clean out pathway.

NOTE: If your SEBO vacuum cleaner has a clog, please refer to the vacuum cleaner owner's manual.

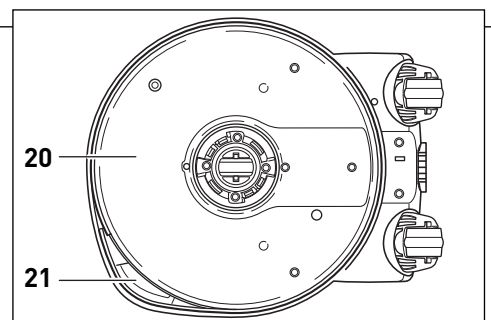

Figure 10

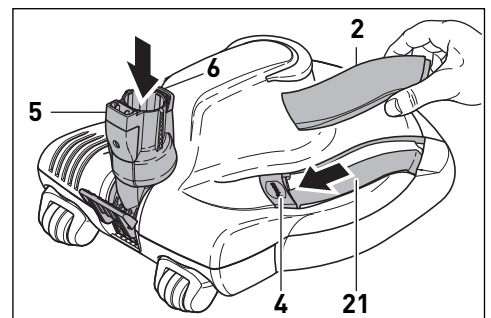

Figure 11

TROUBLE-SHOOTING GUIDE



Always unplug vacuum from outlet before dismantling any part of the machine!

PROBLEM	REASON	SOLUTION
Does not turn on	1. Not plugged into good outlet.	1. Use another outlet.
	2. Cable worn.	2. Replace cable.
	3. The power control slider switch is set to "0" ("off" position).	3. Slide the power control slider switch to "on" position.
	4. The internal switch in the swivel neck is off because the machine is in the upright locked position.	4. Release the foot pedal and lower the handle to operating level. See page 7.
Red LED light is illuminated and machine shuts off	1. Bag full.	1. Replace bag. See your vacuum owner's manual.
	2. Clog in airflow pathway, attachment hose, attachment tube or entrance to dust bag.	2. See Clog Removal in your vacuum owner's manual.
	3. Microfilter dirty.	3. Replace microfilter. See your vacuum owner's manual.
	4. Exhaust filter dirty.	4. Replace exhaust filter. See your vacuum owner's manual.
	5. Clog in floor pad, suction duct or swivel neck	5. See page 8.
Does not pick up	1. Hose/handle assembly not correctly inserted.	1. Reinsert hose/handle assembly making sure that it is lined up properly and is snapped into place. See your vacuum owner's manual.
	2. The power control slider is set to no suction setting.	2. Slide the control to MAX setting. See your vacuum owner's manual.
	3. Filter bag cover not closed.	3. See your vacuum owner's manual.

Check your FELIX owner's manual for more trouble-shooting problems and solutions.

DISCO FLOOR POLISER POWER HEAD

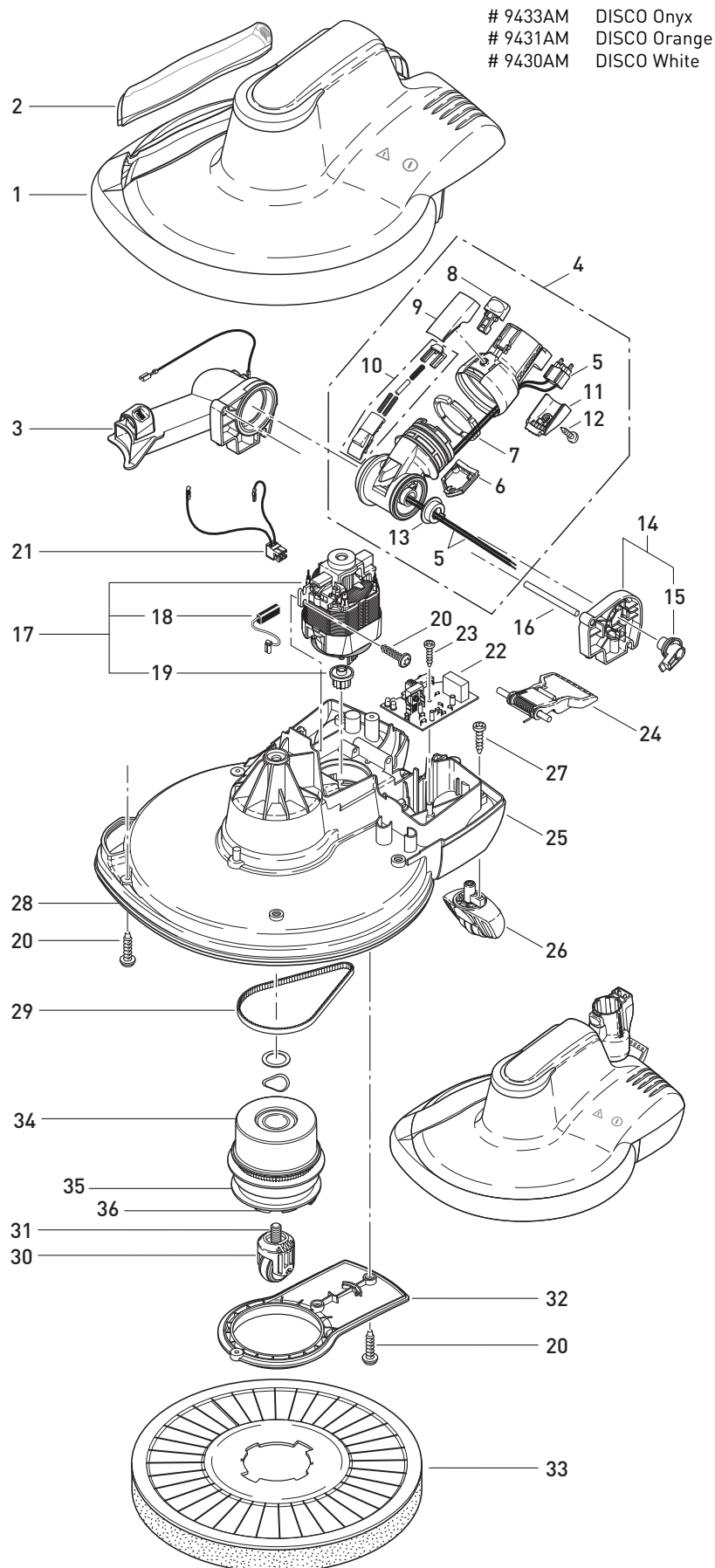

Power Head

9433AM DISCO Onyx Machine (Black)

Pos.	Part #	Description
1	3204SWSE1	Power head cover - black
2	3205TG	Suction duct access cover
3	3258DG	Swivel neck support
4	3226DG	Turning swivel neck
5	0876ER	Wiring for swivel neck
6	2947GS	Cover
7	2950ER	Bearing segments
8	1737GS	Release button w/leaf spring
9	2952GS	Button cover, TS-neck
10	2945GS	Swivel neck slide
11	2951GS	Socket cover, TS-neck
12	01027	Screw F 3.9x9.5 DIN 7981
13	2954	Swivel neck bearing
14	3257ER	Swivel neck support LH
15	3238	Switch lever
16	2938ER	Axle
17	3252ER	Motor 120V (incl pos.18)
18	05141S	Carbon brush set
19	3222	Motor pulley
20	01016	Screw 4x16 T20
21	3245	Internal cable
22	3242ER	Printed circuit board 120V
23	01029	Screw C 2.9x13
24	2937OR	Foot pedal
25	3201DG	Chassis HSB - dark gray
26	3254DG	Rear Castor
27	0102	Screw 3.9x13
28	3268ER	Sealing strip
29	3221	Drive belt
30	3220ER	Center castor
31	01033	Screw M 10x25
32	3202DG	Belt drive cover
33	3230ER00	SEBO floor pad - blue
34	3250ER	Centrifuge
35	3219	Seal
36	3281ER	Pad retainer

9431AM DISCO Orange Machine Exception

1	3204V0SE	Power head cover - orange
---	----------	---------------------------

9430AM DISCO White Machine Exception

1	3204GWSE	Power head cover - white
---	----------	--------------------------